

 **SHERWOOD SCUBA**

SR3

OCTO

OWNER'S MANUAL



**COPYRIGHT SHERWOOD SCUBA
V1.02.2025
SherwoodScuba.com**

SherwoodScuba.com

SHERWOOD SCUBA



SR³

PRO-LEVEL OCTO

The same technology, premium materials, and extraordinary breathing characteristics found in our SR3 Regulator are also available in the SR3 Octopus. The SR3 Octo is distinguished from the SR3 by its highly visible yellow accented front cover and yellow hose. The same single knob performance adjustment and Seat Saving Floating Crown (SSFC) are the features that help the SR3 Octo stand apart from other high-end Octos.

SR³ OCTO

- **Seat Saving Floating Crown (SSFC)** - Extended HP seat life while not in use
- One touch performance adjustment
- Pneumatically balanced 2nd stage
- Hi-Vis yellow 36" hose
- Free parts for life (Restrictions Apply)

PART NUMBERS

SR2005 (SR³ Octo)

The Sherwood Scuba SR3 Octo has been laboratory tested in temperatures of 39°F (4°C). If diving in waters colder than 39°F (4°C) ensure the 1st stage used is set at the lowest value of the IP range as a precaution.

TABLE OF CONTENTS

1.0 INTRODUCTION	5
1.1 WARNINGS, CAUTION & NOTES (DEFINITIONS)	5
1.2 TRAINING REQUIREMENTS	6
1.3 SPECIALTY DIVING SCENARIOS	6
1.4 CHEMICALS, LUBRICANTS & DISINFECTION	7
2.0 INITIAL SET UP	7
3.0 OPERATION	8
4.0 SR³ OCTO COMPONENTS	8
4.1 ADJUSTMENT DURING THE DIVE	9
5.0 AFTER DIVE, STORAGE & SERVICE	10
5.1 AFTER THE DIVE	10
5.2 STORAGE & TRANSPORT	10
5.3 AUTHORIZED SERVICE	10
6.0 LIMITED LIFETIME WARRANTY	11
7.0 APPLICATION & LIMITATIONS	12
7.1 OBSOLESCENCE	13
7.2 COPYRIGHT	13
8.0 SCUBA SYSTEM COMPONENTS	14
9.0 SERVICE RECORDS	15

1.0 INTRODUCTION

Thank you for choosing the Sherwood SR3 Octo!

To get the most satisfying use of this product, please take time to read this entire manual to understand the use and limitations of the SR3 Octo before you attempt to use it. If you have any questions contact your Authorized Sherwood Scuba Dealer for immediate attention or you may contact us at [Sherwood Scuba](http://SherwoodScuba.com).

1.1 WARNINGS, CAUTION & NOTES (DEFINITIONS)

This User's Manual contains signal words that are intended to designate levels of hazardous conditions. These signal words and their designations are as follows:



WARNING indicates a potentially hazardous condition or situation which, if not avoided, could result in death or serious injury.



CAUTION indicates a potentially hazardous condition or situation which, if not avoided, may result in minor or moderate injury.



NOTE is used to address practices not related to personal injury.

1.2 TRAINING REQUIREMENTS



WARNING : Sherwood Scuba equipment is to be used only by individuals trained and certified by a national recognized scuba training agency.

Assembling scuba equipment and/or diving without the necessary training in safety procedures or without observing practices outlined by your training agency for your level of certification is extremely hazardous and could result in serious injury or death. The contents of this manual are not a satisfactory substitute for certified scuba instruction.

1.3 SPECIALTY DIVING SCENARIOS



WARNING : Specialty Diving: This Sherwood Scuba Octo is designed to perform under demanding conditions.

However, before you attempt to participate in specialized diving activity you must receive appropriate training in that specialty. Failure to receive training and to master the skills required for these advanced activities could subject you to conditions that could result in death or serious injury. Some examples of advanced diving activities include, but are not limited to:

Deep Diving - Deeper than the generally recognized recreational diving limit at 40 meters (135 feet) of seawater.

Decompression Diving - At combined depth and duration exposures requiring mandatory decompression stops.

Cold Water Diving - Diving in water temperatures less than 10°C (50°F) may require special techniques to avoid conditions that could result in freezing conditions inside regulators and valves. Training should include problem avoidance techniques and emergency procedures for dealing with uncontrolled gas flow from the regulator or valve.

Cave or Wreck Diving- Diving in any situation that provides an overhead environment requires knowledge of the hazards associated with such a location and specialized configuration of your diving equipment including the proper set up of the alternate breathing supply. Failure to observe recommended practices could result in death or serious injury.

1.0 INTRODUCTION



WARNING : Multiple Divers: For escape purposes; if a scuba system using this Sherwood Octo is configured to be used by more than one diver at the same time, then it **shall not be used at depths greater than 30 meters and in water temperature not below 10°C.**

The use of an auxiliary emergency breathing system using the same 1st Stage in temperature less than 10°C is not a preferred configuration & the use of alternative fully independent systems is advised. Only SCUBA systems in compliance with (EU) 2016/425, (UK) 2016/425 as brought into UK law and amended and EN250:2014 can be used as an escape device by more than one user at the same time.

1.4 CHEMICALS, LUBRICANTS & DISINFECTION



CAUTION : Chemicals and Lubricants : Do not use any lubricants on your Octo between service overhauls or inspections.

No additional lubrication is required and the use of improper lubricant could introduce conditions adverse to respiratory health or increase the risk of fire hazard.



CAUTION : Disinfection : To minimize the risk of pathogen growth inside your regulator's 2nd Stage and mouthpiece areas is recommended to use a proper disinfection method after diving & before storing your Octo.

In addition to fresh water rinse to minimize mineral build up also prepare a suitable disinfectant solution that can be a commercially available one such as Sterainios 2% (Glutaraldehyde). Submerge the Octo in the solution for 3 - 5 minutes, remove from solution rinse off with abundant clean fresh water.

[Click here](#) for additional information.

If the recommended solution is not available in your location, prepare a mix of water & bleach at a 10% concentration but no less than 4%. Submerge the Octo independently from the rest of the regulator for 2 - 3 minutes. Rinse again with abundant fresh water to wash out the disinfectant residues. Be mindful that if you leave the Octo inside the disinfectant solution for long periods of time, or it is not rinsed properly the chemicals could affect the components of the Octo. The use of the recommended disinfection solutions will not have an adverse effect when used as indicated within this instructions.

2.0 INITIAL SET UP

[Click here](#) to register your ownership of your new SR³ Octo.

Registration is necessary to participate in Sherwood's free service parts program and to receive product update notices. (Find more information regarding the free parts program in page #11 of this manual).

Your Authorized Sherwood Dealer is an excellent resource for setting up your Octo the first use such as the installation of important ancillary devices such as a Submersible Pressure Gauge or Dive Computer, Alternate Air Source & Buoyancy Compensator, as well as the initial system pressurization and any fine tune final details your Octo may need before diving with it for the first time.

The proper installation & testing of those additional components on your Octo should be left to a qualified technician.

Before Each Dive - Inspect your Octo and all associated equipment for loose or missing parts or evidence of damage. Do not use the Octo until loose or damaged parts are repaired or properly adjusted. Connect the Octo to a cylinder. Pressurize the system. Test the Octo by purging the 2nd Stage a few times & then breath through it while at the surface before entering the water. Operating the purge alone does not adequately check the Octo for proper operation. Check the entire system for signs of air leakage, inspect tank valve O-ring & correct or replace if necessary but if leakage persist contact your Sherwood service center.

After your Octo & all associated equipment has been properly tested and you are sure there are no leaks perform simple test dive in shallow water in a controlled environment such as a pool to verify that the system performs normally and you are familiar with its operating characteristics. Such a test dive may expose potential problems before you arrive at your final dive destination and will assist on avoiding potentially disappointing or hazardous scenarios.

3.0 OPERATION

The SR3 octo should be connected to a proper FIRST STAGE providing an IP output rage of 125 - 145 psi (8.5 - 10.0 bar), that in turn connects to a cylinder using a valve that complies with EN ISO 12209: 213.

4.0 SR³ OCTO ADJUSTMENTS

4.1 ADJUSTMENT DURING THE DIVE

The Sherwood SR³ Octo has only one adjustment. Adjusting the Octo Knob affects both, the initial breathing effort and the Venturi assisting effect. The operation of the knob is the same as most regulators of this type. The easiest way to remember the operation is to think of a water faucet. You turn the faucet clockwise to reduce the flow and the opposite way to increase it.

Also, note that when the knob is rolled inwards, to reduce flow, we call it fully "IN" and when it is rolled outwards, to maximize flow, we call it fully "OUT".

IN : Reduced Flow



OUT : Maximum Flow



5.0 AFTER DIVE, STORAGE & SERVICE

When diving at the surface or when the Octo is out of the water, it is important to adjust the Octo sensitivity to the least sensitive position (rolled back, fully "IN") to stop the venturi assisting effect and minimize the possibility of uncontrolled free flow of air. While diving, it is recommended that the Octo be operated at the greatest sensitivity available without causing the Octo to free flow. Breathing with greater resistance will not conserve air and, in fact, may result in more breathing effort and increased air consumption.

5.1 AFTER THE DIVE

As soon as possible after any diving activity, It is recommended that the FIRST STAGE the SR3 octo is connected to be rinsed in fresh water WHILE IT IS STILL PRESSURIZED. Rinsing while pressurized will prevent the introduction of contaminants into the sealing areas of the Octo and preserve reliability. If it is not possible to rinse while pressurized, be certain to keep Water & contaminants away from the inlet of the first stage this SR3 Octo is connected to. Dry the inlet area of your first stage well and the inside of the dust cap, then, put the dust cap back on & secure it before a attempting to rinse the Octo. DO NOT operate the purge of the SR3 Octo while rinsing particularly when the 1st stage is not pressurized. Operating the purge, without pressure from the hose, opens the second stage valve and increases the risk of water & contaminants entering the second stage inner components.

If the Octo is additionally going to be used consistently for pool training, be mindful that all the chemicals in pool water are even more harsh than just ocean water. Be more thorough while rinsing, and consult with a Sherwood technician to find out if your Octo is going to require to be serviced more often.

5.2 STORAGE & TRANSPORT

Be certain the Octo is dry before storage to minimize opportunities for bacteria or fungal growth. Although the Octo will tolerate short periods of temperature extremes between -20°C & 70°C (-4° F & 160° F), it should be stored inside a regulator bag at room temperature between 15°C - 29°C (59°F -85°F) and away from direct sunlight (UV) exposure to maximize the life of the various components in the Octo. Although your Sherwood Octo is made out of very high-quality components it is advised to transport your Octo using an appropriate padded carrying bag to prevent damages during transportation.

5.3 AUTHORIZED SERVICE

In order to maintain the product warranty and optimum performance, your Sherwood Octo must be inspected annually and receive service from an Authorized Sherwood Scuba Dealer every 24 months or 300 hours of use, whichever comes first. Service includes disassembly, cleaning, inspection, replacement of service kit parts, lubrication as necessary and adjustment for optimal performance. [Click here](#) for assistance in locating an Authorized Sherwood Scuba Dealer.

6.0 LIMITED LIFETIME WARRANTY

Sherwood Scuba warrants that the SR³ model Octo purchased from Authorized Sherwood Dealers shall be free of defects in workmanship and materials for the lifetime of the original purchaser.

Under this warranty Sherwood will either repair or replace, at its sole option, any original parts that fail to perform as intended. This warranty excludes products subject to abuse, neglect, alterations or improper unauthorized service. Warranty also excludes parts subject to wear such as hoses, mouthpieces, seals, and metal parts with mild corrosion from exposure to seawater.

Under this warranty plan, Sherwood will replace warranted parts but the labor to replace such parts is excluded and is the responsibility of the owner.

In order to use this warranty, you must provide proof of purchase from an Authorized Sherwood Scuba Dealer. Save your receipts as proof of purchase. If you are unsure as to whether a dealer is authorized, contact us at www.SherwoodScuba.com.



WARNING : Aside of fresh water rinsing after every dive & the storage precautions discussed in this manual, this Sherwood Octo does not have end-user serviceable components nor service protocols that are intended for the end-user to perform.

Under certain circumstances you may be eligible for free service parts. Consult your Authorized Sherwood Dealer to determine eligibility.

To qualify for the free service parts program, you must:

1. Purchase your SR³ Octo from an Authorized Sherwood Scuba Dealer.
2. Register your SR³ Octo via SherwoodScuba.com within 30 days following purchase, the registration must include your regulator's serial number linked to your name as the original purchaser.
3. Obtain an inspection of the SR³ Octo annually by an Authorized Sherwood Scuba service center and retain proof of inspection.
4. Obtain a complete service (complete product overhaul), by an Authorized Sherwood Scuba service center a year after inspection & at intervals not exceeding 24 months or 300 hours of use. Retain proof of complete product overhaul.
5. Present a copy of the original sales receipt and proof of annual inspection.

Note: Free parts program does not include the cost of labor to service or inspect.

Sherwood Scuba specifically disclaims liability for any consequential, special or indirect damages arising out of the use of your Sherwood Scuba Octo.

Warranty laws in your state or location may affect your rights and should be consulted if you believe the terms of the warranty do not apply to you.

7.0 APPLICATION & LIMITATIONS

The Sherwood Octo described in this manual is only intended for underwater diving & must be used in conjunction with a complete scuba system.

In compliance with Regulation 2016/425 & UK Regulation 2016/425 as brought into UK law and amended, Chapter IV, Article 18, Annex I & Annex II Clause 1.4 (h) this demand Octo is considered a Personal Protective Equipment Category III; (b) atmospheres with oxygen deficiency & (i) drowning. This Sherwood SR³ Octo is designed to provide the diver with a breathable gas mixture while in an underwater environment. The HP port on the 1st Stage of the SR³ allows the diver to install a pressure indicator that can warn the diver of an approaching failure of the breathable gaseous mixture..

In compliance with the EN250: 2014 standard, this diving Octo is expected to only be used with breathable compressed air. This breathable air must comply with the EN 12021: 2014 standard.

In compliance with the EN250 standard, this Octo was tested at a water temperature 4°C & marked EN250 A.

This Sherwood regulator is intended for scuba diving in a subaquatic environment only & recreational purpose. This regulator is not intended for subaquatic jobs requiring specific protection for the breathing equipment. In particular, this equipment is not intended for diving in highly contaminated water & very poor visibility, (chemical products, water with large quantities of suspended solids or hazardous pathogens). Regardless of your underwater activity or the type of work intended, an air outage is a major risk to consider in autonomous diving. Your Octo must be connected to the appropriate & sufficient volume of breathable air for your planned dive.

This Sherwood Octo is certified for a depth of 50 meters.

The Sherwood SR³ Octo described in this manual must be used in conjunction with the following items:

1. Cylinder(s) with valve(s) containing compressed air complying with EN 12021: 2014
2. Breathing gas pressure indicator
3. Facepiece: complete mouthpiece or half-mask for diving or complete mask;
4. Carrying system.

***The apparatus may also include the following sub-components:**

5. Auxiliary breathing system
6. Manually operated buoyancy control system that may include releasable ballast.
7. Depth/time measuring device
8. Additional safety device(s)
9. Voice communication system

***NOTICE:** Items 5 to 9 could be considered additional items used with the intention to minimize risks.

7.0 APPLICATION & LIMITATIONS

7.1 OBSOLESCENCE

Sherwood Scuba considers 2 criteria of obsolescence:

1. Obsolescence of the replaceable components during a bi-annual overhaul (2 years after the original date of purchase from an authorized dealer), those components become obsolete every time the Octo goes in for service at any authorized dealer.
2. Obsolescence of a Octo model after it is out of production. Sherwood Scuba commits to suport (with service kits, spare parts & technical support) each particuar Octo model for a perod of 10 years after the date a particular Octo model has no longer being produced.

[Click here](#) to contact us if you have doubts or concerns regarding your product obsolescence.

7.2 COPYRIGHT

This user's manual is protected by the copyright law of March 11, 1957 regarding artistic & literary property. This manual may not be reproduced, copied, photocopied, or altered by any means; digital or analogue, in whole or in part, without prior consent in writing from Sherwood Scuba.

Sherwood Scuba is the manufacturer of this Octo, 6161 Atlantic Boulevard, Norcross, GA 30071 - USA.

EU Distributor: Technical Diving Courses F.F. ULRIKSGADE 34 2100 COPENHAGEN, DENMARK

UK Distributor: Midland Diving Equipment 57 SPARKENHOE STREET LEICESTER, ENGLAND LE2 ODT

8.0 SCUBA SYSTEM COMPONENTS

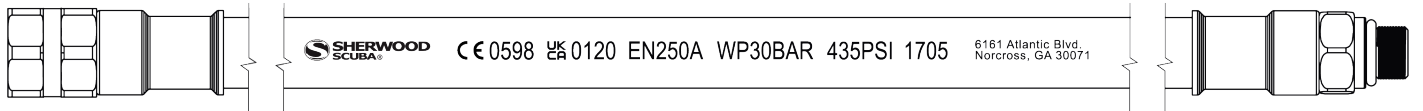
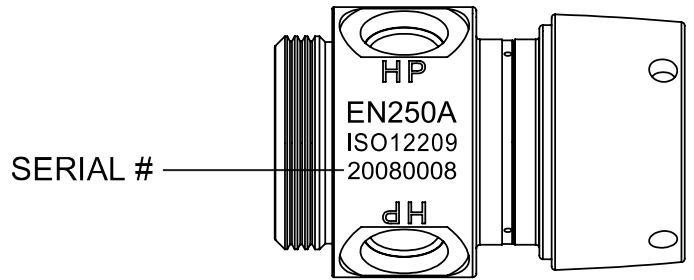
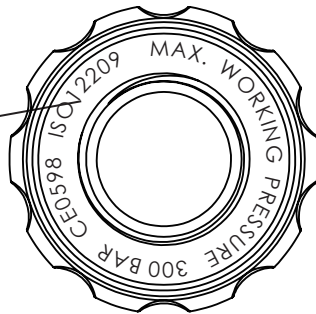
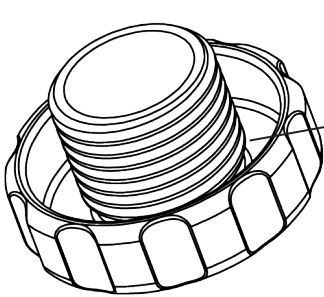
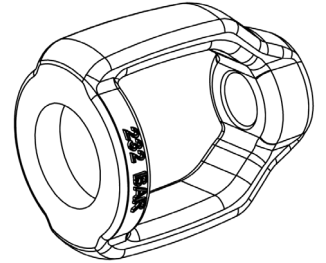
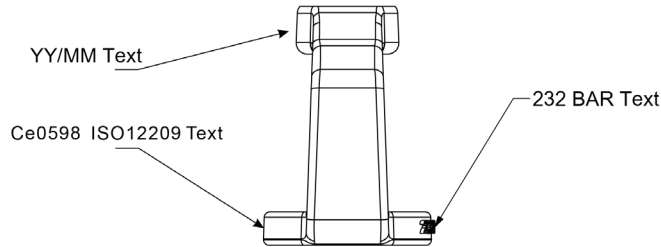
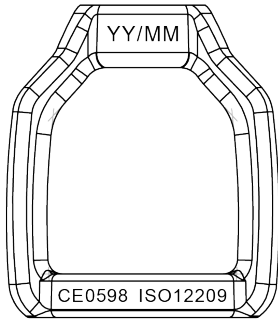

SERIAL #

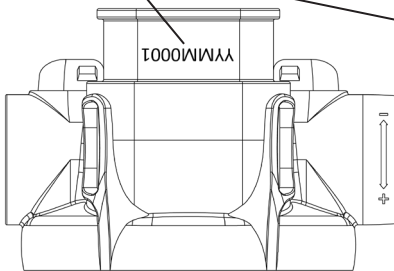

SR³ REGULATOR

9.0 SERVICE RECORDS

OCTOPUS SERIAL NUMBER : _____

DATE OF PURCHASE : _____

BELOW TO BE FILLED IN BY AN AUTHORIZED SHERWOOD SCUBA DEALER :

DATE	DEALER/TECHNICIAN	ADDRESS	SIGNATURE

[CLICK HERE TO DIGITALLY ENTER SERVICE RECORDS](#)

**COPYRIGHT SHERWOOD SCUBA
V1.02.2025
SherwoodScuba.com**