

ALUMINUM FLASHLIGHTS

SHERWOOD SCUBA

PartNumbers:

ST 1 0 0 0

ST 2 8 0 0

USER'S MANUAL



ST1000



ST2800

INCLUDED ITEMS

ST1000 = 1000 lumen light | ST2800 = 2800 lumen light

USB charging cable

Lithium-ion battery

Spare O-ring seal

Wrist lanyard

Reusable zippered case

Important Prior To Use:**O-RING SEAL**

Inspect the O-ring seal to be sure it is clean and free of dust, debris, hair, sand, etc. before using underwater. Lightly lubricate the O-ring seal with silicone grease prior to use and maintain lubrication at all times.

RECHARGING LITHIUM-ION BATTERIES

WARNING: DO NOT RECHARGE THE BATTERY NEAR FLAMMABLE ITEMS AND/OR PRODUCTS. Do not leave plugged in for more than 12 hours.

- Unscrew the end cap.
- Plug in USB cable.
- A red LED indicates that the light is charging.
- When charging is complete, the LED turns green.
- Fully screw down the end cap.

WARNING: When using rechargeable lithium-ion batteries use only the included batteries or batteries sold by major manufacturers that have the same voltage, mAh and watt hour ratings as original batteries. Batteries must include over / under voltage protection circuit.

RECHARGEABLE BATTERIES

Burn time/Brightness:

ST1000 - 1.0 hr at 100%, 2.0 hr at 50%, 3.5 hr at SOS Strobe, 7.0 hr at 25%

ST2800 - 1.5 hr at 100%, 2.5 hr at 50%, 2.0 hr at SOS Strobe

Burn-time of the lamps is affected by:

(A) - *Operating temperature* – Do not use at highly elevated temperatures for extended periods of time.

(B) - *Storage temperature* – Store in a cool and dry place at room temperature (68-77° Fahrenheit / 20-25° Celsius).

(C) - *Time period the light was out of use.* For extended storage, discharge a lithium-ion battery to about 40 percent (or approximately 1 hour on a fully charged battery) and store it in a cool, dry place. **Warning: *always take batteries out of light when storing longer than 30 days.***

(D) - *Avoid completely discharging lithium ion batteries* – Battery experts suggest that after 30 charges, you should allow lithium-ion batteries to almost completely discharge. Continuous partial discharges create a condition called digital memory, decreasing the accuracy of the device's power gauge. So let the battery discharge to the cut-off point and then recharge. The power gauge will be recalibrated. For safety reasons, do not recharge deeply discharged lithium-ion batteries if they have been stored in that condition for several months.

BATTERY DISPOSAL

Rechargeable lithium-ion batteries must be disposed of or recycled in compliance with all applicable laws.

Never throw into a fire, as batteries may explode. Keep batteries away from children

WARNINGS

- Light is for underwater use only.
- Remove the batteries during transport.
- Remove the batteries if the light will not be used for long periods.
- If you anticipate extended periods of non-use, recharge the battery every 3 months.
- Make sure the end cap is closed tightly before each dive.
- Never point the light directly into eyes.

CHARGE INDICATION SWITCH

This light features a color charge indication around the on/off switch with multiple modes. The light works at 100% power, 50% power, and SOS signaling modes. Push the on/off button and release to move between modes. After four seconds of use in any mode pushing the power button will power off the light. This light features a battery life indicator around the on/off switch. It glows green at full battery charge, yellow at half battery charge and red at low battery charge. It will flash red before shutting off.

ROUTINE MAINTENANCE

- **After every dive, wash thoroughly in fresh running water to remove any sand as well as dirt and salt.**
- **NEVER disassemble the light.**
- **Periodically check the condition of the O-ring seal and lubricate with silicone grease on a regular basis and replace as needed.**

WARRANTY

We want you to be 100% satisfied with your purchase. If for any reason your light fails or malfunctions, you can return it within 12 months of consumer purchase for repair and/or replacement. **Proof of Purchase from an authorized dealer within the past 12 months must be included with all warranty returns.** Please return your light to the place of purchase. Commercial and rental use is not covered. Any lights or batteries that have been disassembled void warranty. Warranty is not transferable.

Contact Details:

Sherwood Scuba

<https://www.sherwoodscuba.com/contact-us/contact-info>

www.SherwoodScuba.com

ST1000 EXPLODED VIEW

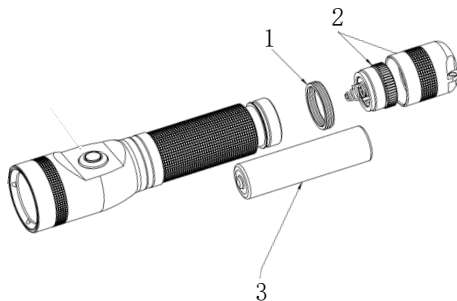

3	IT18650-A	ST1000 BATTERY
2	ST1000-ECCS	REPL. ST1000 ENDCAP/CHARGING CONTROL SET
1	ST1000-ORING	ST1000 O-RING SLEEVE

ST2800 EXPLODED VIEW

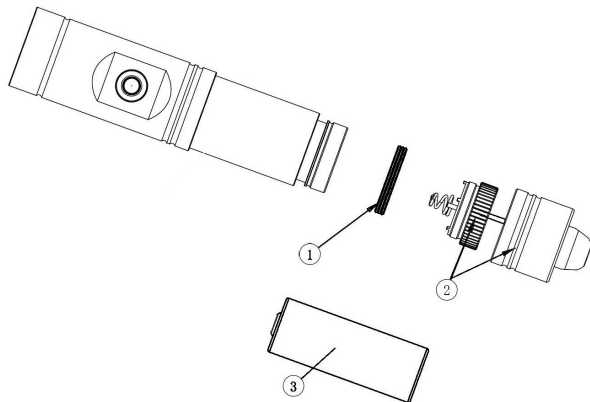

3	26650BAT	ST2800 BATTERY		1
2	ST2800-ECCS	ST2800 ENDCAP/ CHARGING CONTROL SET		1
1	ST2800-ORING	ST2800 O-RING SLEEVE		1

